

BENNETTS CREEK PROJECT CONDITION SURVEY OF MARCH 2010 SUFFOLK, VIRGINIA

COORDINATES OF CENTERLINE STATIONS		
STATION	EAST (X)	NORTH (Y)
0+00.0	12,072,930.17	3,485,404.10
33+50.1	12,073,463.63	3,488,711.41

— LEGEND —

TOE OF AUTHORIZED CHANNEL

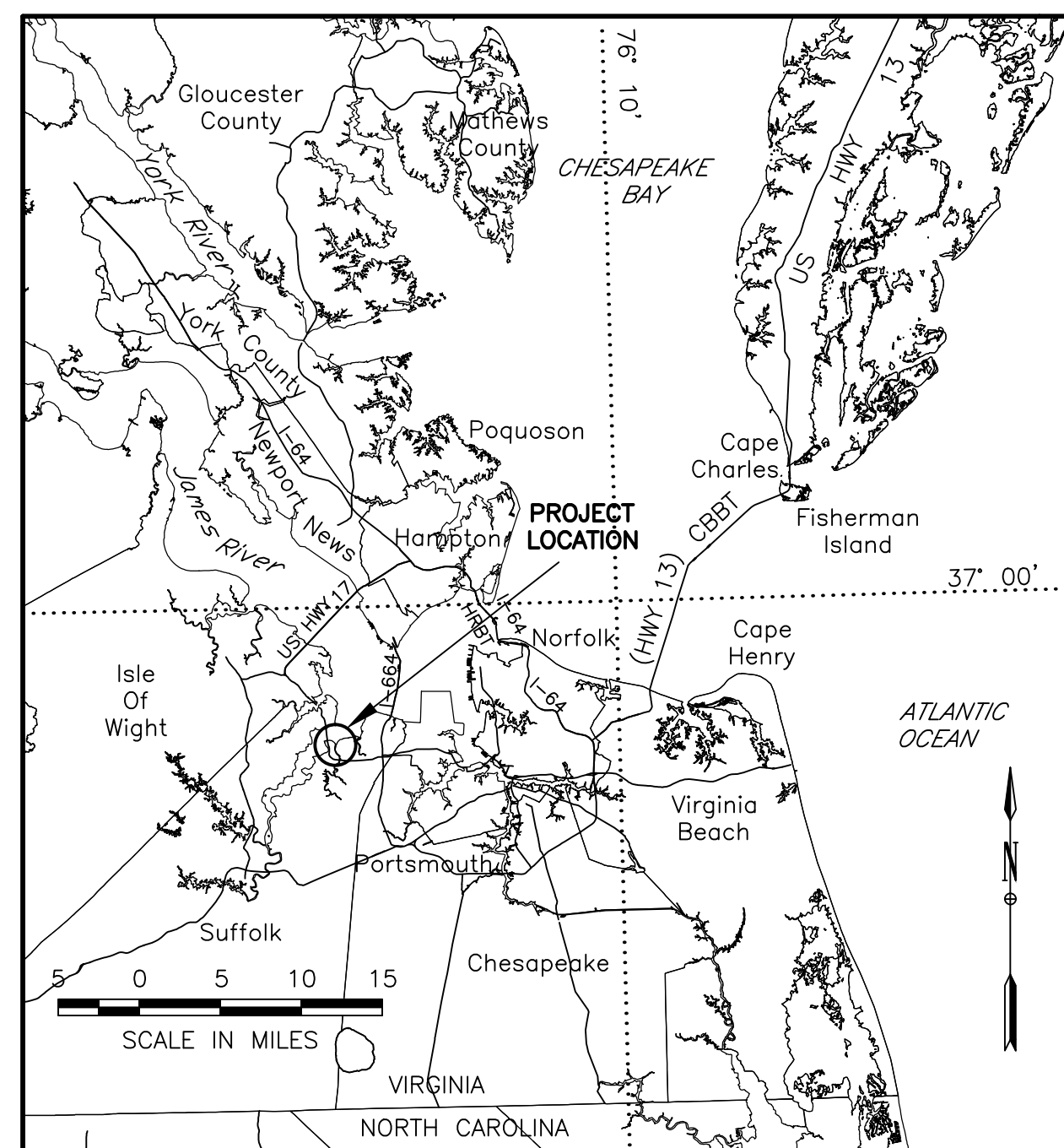

VICINITY MAP

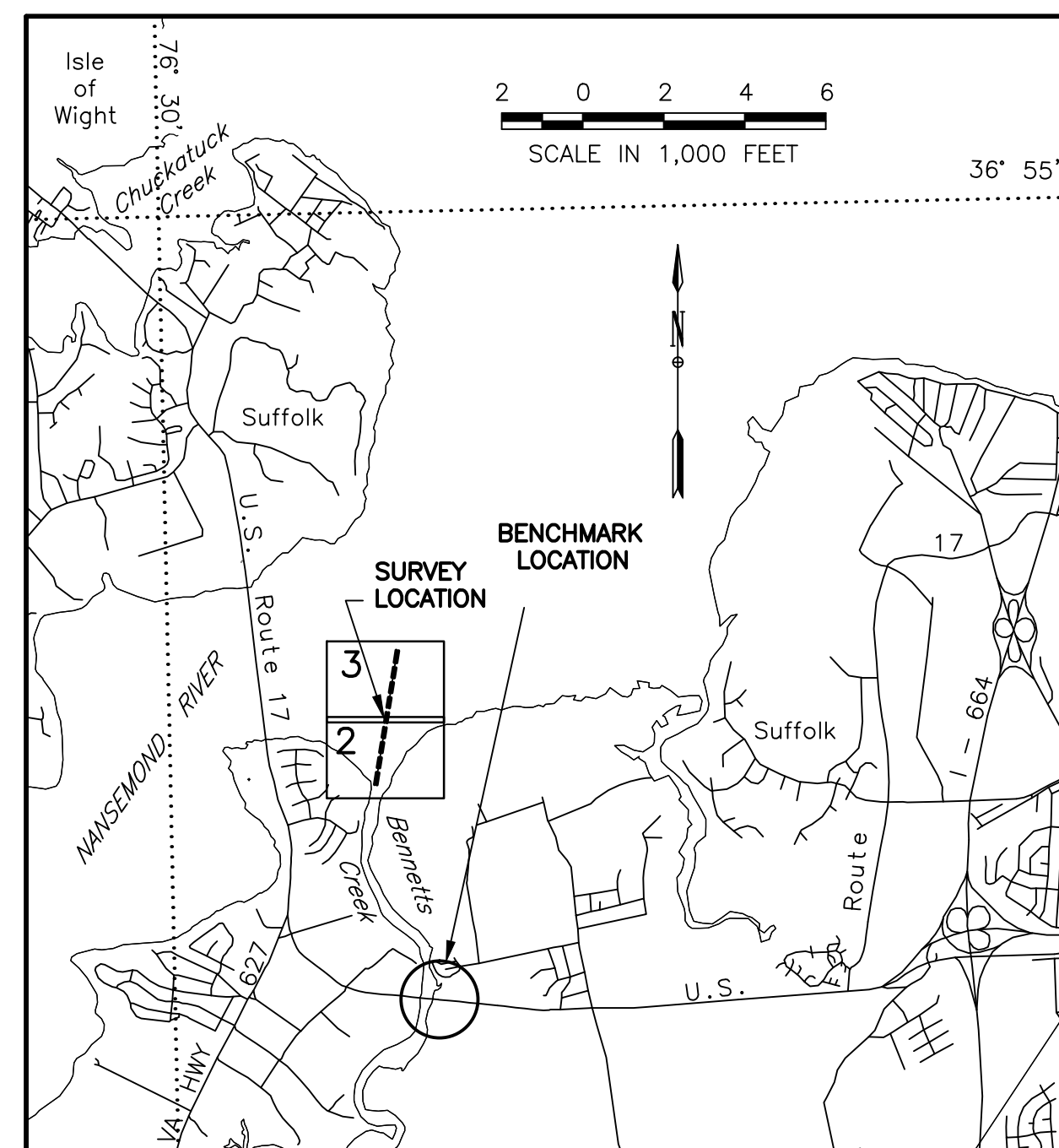

LOCATION MAP

— NOTES —

PROJECT DIMENSIONS: A channel 6 feet deep and 60 feet wide.

MEAN LOWER LOW WATER (MLLW), National Tidal Datum Epoch (NTDE) 1960–1978, was determined by interpolating between MLLW–NGVD differentials at Old Nix Clubhouse Site, Nansemond River and Pig Point, Nansemond River Entrance, using National Ocean Service (NOS) tidal observations. Update values to NTDE 1983–2001 was accomplished using values determined by the National Ocean Service (NOS) at Sewells Point, Hampton Roads. MLLW, NTDE 1983–2001, is 1.62 feet below the North American Vertical Datum of 1988 (NAVD–88) at USC&GS monument M 309 Reset, 1967.

SOUNDINGS are in feet referred to NOS MLLW and were taken on 10 March 2010. The darkened sounding(s) depicts the controlling depth(s) for this channel/reach.

MEAN RANGE OF TIDE is 3.0 feet at Town Point, Virginia based on NOS observations, NTDE 1983–2001.

COORDINATES are referred to the Virginia State Plane Coordinate System, South Zone in U.S. survey feet, and are based on the North American Datum of 1983.

PLANIMETRIC FEATURES were developed by stereo-photogrammetric methods from aerial photos flown 4 September 2002 by EarthData International of Maryland.

LAST DREDGED by Hampton Roads Leasing Company during 17 October through 6 December 2006 under Contract No. W91236–06–C–0061 dated 22 August 2006.

BENCHMARKS	
BENCHMARKS	ELEVATIONS
CE "NAT, 2003"	+4.77'
CE "LAURA, 2003"	+12.31'
USC&GS "M 309 RESET, 1971"	+29.50'
ELEVATIONS ARE RELATIVE TO NOS MLLW, 1983–2001 NTDE	

INDEX TO DRAWINGS

SHEET NO.	TITLE	FILE NUMBER
1	TITLE SHEET	FILE NO. H-11-17-33(1)
2	MAPPING SHEET	FILE NO. H-11-17-33(2)
3	MAPPING SHEET	FILE NO. H-11-17-33(3)

The information depicted on this map represents the results of surveys made on the date(s) indicated and can only be considered as indicating the general conditions existing at that time.

DEPARTMENT OF THE ARMY
NORFOLK DISTRICT, CORPS OF ENGINEERS
NORFOLK, VIRGINIA

REVIEWED: _____ APPROVED: _____
CHIEF, NAVIGATION SUPPORT AND SURVEY SECTION CHIEF, OPERATIONS BRANCH

SUBMITTED: _____ APPROVED: _____
CHIEF, DESIGN SECTION CHIEF, TECHNICAL SERVICES DIVISION

SIGNATURES AFFIXED BELOW INDICATE OFFICIAL RECOMMENDATION AND APPROVAL OF ALL DRAWINGS IN THIS SET AS INDICATED ON INDEX TO DRAWINGS.

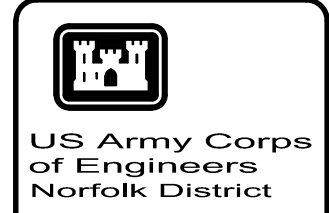

REV.	DATE	DESCRIPTION	BY	APP.

DESIGNED: G.G.W.	CHECKED: R.J.W.	DATE: 14 JUN 10
DRAWN: C.S.R.	SCALE: AS SHOWN	
PRODUCT NO.: H-11-17-33(1)	DRAWING NO.: A.M.P.	
NORFOLK DISTRICT CORPS OF ENGINEERS NORFOLK, VIRGINIA		

BENNETTS CREEK
PROJECT CONDITION
SURVEY OF MARCH 2010
SUFFOLK, VIRGINIA

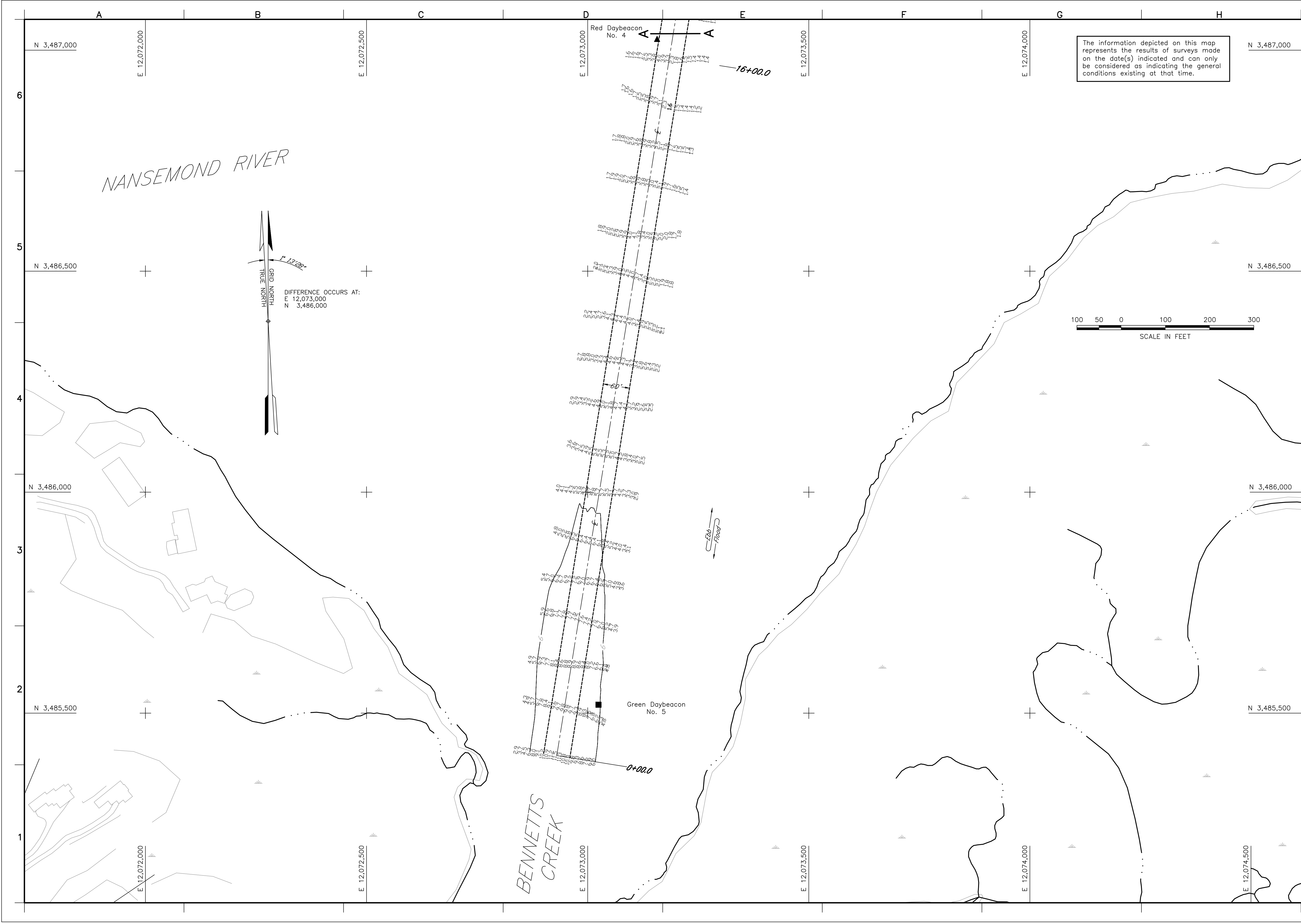

The information depicted on this map represents the results of surveys made on the date(s) indicated and can only be considered as indicating the general conditions existing at that time.

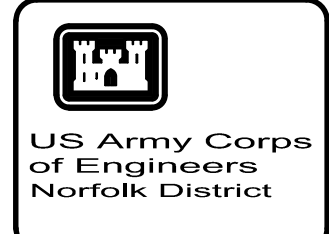

REV.	DATE	DESCRIPTION	BY	APP.

DESIGNED BY: G.G.W.	CHECKED BY: R.J.W.	DATE: 14 JUN 10
DRAWN BY: C.S.R.	SUBMITTED BY: G.G.W.	SCALE: AS SHOWN
PROJECT NO.: H-11-17-53(2)	NORFOLK DISTRICT	
DRAWING NO.:	CORPS OF ENGINEERS	
SURVEYED BY: A.M.P.	NORFOLK, VIRGINIA	

**BENNETTS CREEK
PROJECT CONDITION
SURVEY OF MARCH 2010
SUFFOLK, VIRGINIA**

A B C D E F G H

E 12,072,000

E 12,072,500

E 12,073,000

E 12,073,500

E 12,074,000

E 12,074,500

6

5

4

3

2

1

N 3,488,500

N 3,488,000

N 3,487,500

N 3,487,000

E 12,072,000

E 12,072,500

E 12,073,000

E 12,073,500

E 12,074,000

N 3,487,000

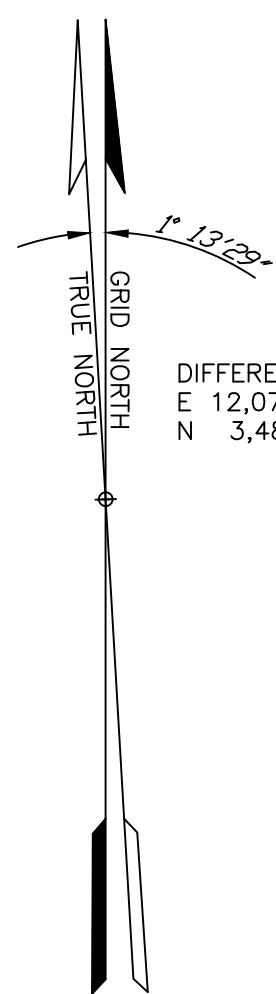

DIFFERENCE OCCURS AT:
E 12,073,000
N 3,488,000

NANSEMOND RIVER

33+50.1

Green Beacon
No. 1BC (FI G)

Red Daybeacon
No. 2

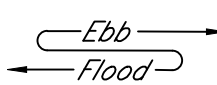

60

Red Daybeacon
No. 4

16+00.0

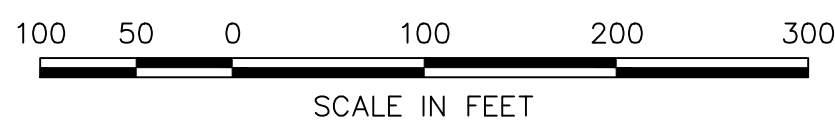

SCALE IN FEET

The information depicted on this map represents the results of surveys made on the date(s) indicated and can only be considered as indicating the general conditions existing at that time.

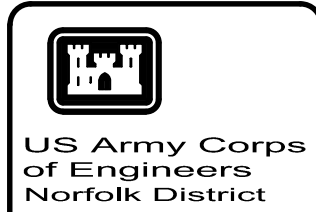

REV.	DATE	DESCRIPTION	BY	APP.

DESIGNED BY: G.G.W.	CHECKED BY: R.J.W.	DATE: 14 JUN 10
DRAWN BY: C.S.R.	SUBMITTED BY: G.G.W.	SCALE: AS SHOWN
PROJECT NO.:	DRAWING NO.:	NORFOLK DISTRICT PROJECT NO.: H-11-17-53(3)
SURVEYED BY: A.M.P.		

BENNETTS CREEK
PROJECT CONDITION
SURVEY OF MARCH 2010
SUFFOLK, VIRGINIA